

25 The numbers indicate the location of each classroom's stall. Please see the next page for a description of each stall.

ENTERPRISE DAY 2015

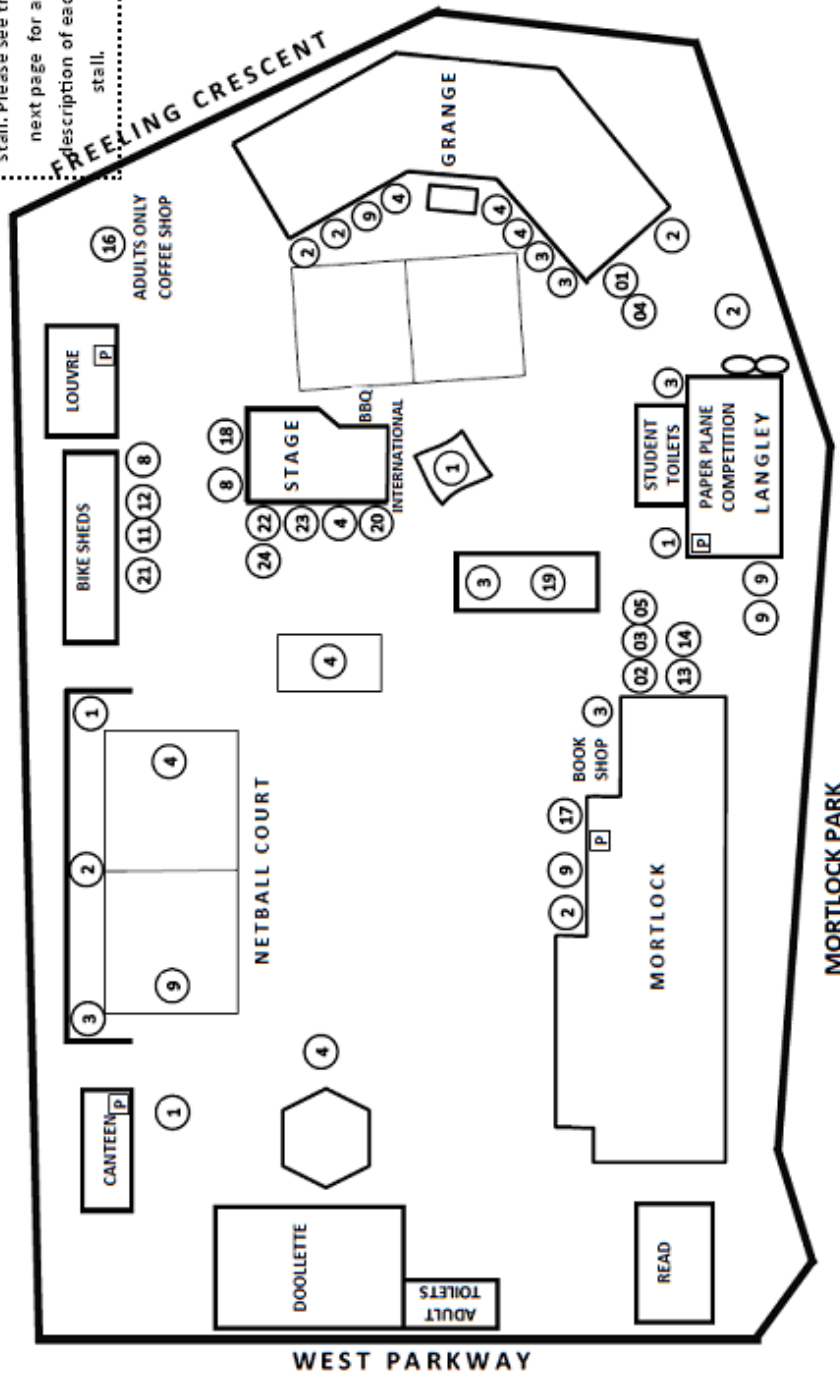

Enterprise Day

9 April 2015

12.30pm-2.00pm

Dear Parents, Relatives and Community Friends

Welcome to our 2015 Enterprise Day, an example of real-life learning for our students. We hope the information below helps you enjoy the day:

Sales take place from 12.:30 to 2:00pm only, no 'early bird' sales.

Students *may bring between \$5 and \$15*, depending upon their age.

Students will need a shopping bag to carry their purchases – and so may you!

Canteen: There will be no canteen for either recess or lunch on Enterprise Day.

Parking: In the laneway and on West Parkway (be gone before 3pm); at the Baseball Club car park and walk across the oval; and in the streets surrounding the school. Please be considerate of our neighbours and do not park across or very close to driveways.

Help and questions: See a member of the school staff, all wearing orange high-visibility vests.

First Aid : Available at the School Office.

Toilets for adults: Please use the toilets at the Doolette building. You should not use children's toilets.

Rest and Quiet: A 'Café' is especially reserved for adult use, where you will be waited on 'hand and foot' by our students. This is in the area near Grange.

Lunch: A selection of curries with rice (including a vegetarian option) near the shady tree, Rice Balls near the Mortlock building or a sausage sizzle under the shady tree.

Students will be dismissed at 3.10pm. Please do not take students early, as the review process from 2.30 to 3:10pm is an important part of their learning.

TEACHERS	ROOM #	ACTIVITY/FOOD/DRINK STALL	PRICE GUIDE	LOCATION
Blight	1	Henna Tattoos Speed Throw Bin Ball Mexican Food	20c - \$5 50c - \$2 50c - \$2 \$3 - \$7	Shade Sails Netball Court Canteen Langley
Brown	2	Sweet & Sour Lolly Bomb Cream Pies Water Balloon Madness Wheel of FUNtune Soccer Shoot Out	50c - \$1 50c - \$2 50c - 90c 10c - \$1 99c 20c - \$4	Mortlock Grange Between Langley & Grange Grange Grange Netball Court
Frances	3	Dippy Docus Splash Pop Origami Crafty Monkeys Lucky Popsticks One Bounce	50c - \$1 30c 10c - \$2 Up to \$1 10c - 50c 30c - 50c	Grange Between Langley & Grange Mortlock Shelter Shed near Mortlock Grange Court
Braybrook	4	Baked Goods Lucky Goo, Lucky You Tattoos Mini Soccer Game Pet Rocks Ping Pong Cup Basketball Hoops	20c - \$1 50c 30c - 60c 50c 50c - \$1 \$1 30c	Stage Grange Grange Near Netball Court Grange Near Netball Court Netball Court
Hammerl & Darrell	8	Happy Thoughts Craft Lollies	\$1 - \$1.50 50c - \$2	Bike Sheds Stage
Weaver	9	Marshmallow Mania Sugar Rush Sweet Stall Bulls Eye Pie Face Disgusting Desserts	\$2 30c - \$1 \$1 - \$3 50c 50c - \$1	Mortlock Grange Netball Court Mortlock & Langley Between Mortlock & Langley

TEACHERS	ROOM #	ACTIVITY/FOOD/DRINK STALL	PRICE GUIDE	LOCATION
Perry & Coutts	11 & 12	Craft	60c - \$2	Bike Sheds
Ellidge & Truscott	13 & 14	Cheerio Bracelets	20c	Mortlock
Gill	16	Coffee Shop	\$2.50	LOUVRE
Cunningham	17	Rice Balls Guess the Lollies in the Jar	80c 50c	Mortlock
Waye	18	Save the Bees	20c - \$1	Stage
Norman	19	White Elephant Stall	10c - \$5	Shelter Shed near Mortlock
McSkimming	20	Fruit Boxes & Spiders	\$1 - \$2	Stage
Welford	21	Craft	20c - \$2	Bike Sheds
Elder & Palmer	22	Mocktails	50c	Stage
Lawrence	23	Fruit Kebabs & Popcorn	50c - \$1	Stage
De Pierro & Scicchitano	01 & 04	Chalk Drawing	20c	Grange
Grant, Hawkes & Pudney	02, 03 & 05	Lucky Dip	20c - 50c	Mortlock
Percy	Library	Ye Olde Book Shoppe	50c	Mortlock
Boothey	PE	Paper Plane Competition	50c	Langley Hall
Sports Committee		BBQ	\$2	Stage
Woollard & parents		International Food	\$6	Stage